

Packing Away The CuddleCot

1. Switch off the unit by pressing the power button but do not unplug until the fan stops operation.

2. Disconnect the cooling pad from the hose by pressing the release clips on the hose. Clean the pad according to hospital or your organisation's procedures.

3. Disconnect the hose from the unit by pressing down the plastic button on the underside of the control unit and gently pulling on the hose.



4. Drain the water from the unit by inserting the drain key under the fluid level tank. For long term storage (30 days+), also drain the hose by inserting the key into the hose.

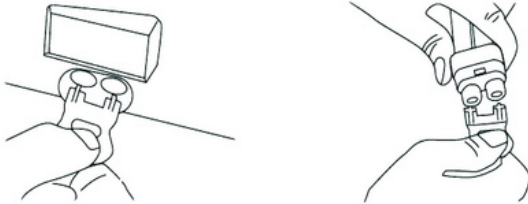

General Maintenance & Power Cord Warning

If dust builds up around the fan, remove the cover and wipe clean. Used cold pads should ideally be replaced every 12mths.

If the supply cord is damaged, it must be replaced by Flexmort, its service agent or similarly qualified persons, in order to avoid a hazard.

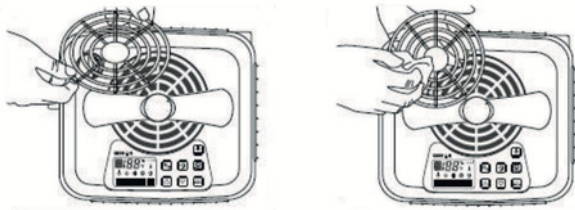

Warranty

The unit comes with a 12 months warranty which can be extended. Please contact Parmed at service@parmed.com.au
For spare parts please contact us at service@parmed.com.au



The CuddleCot cooling system quietly cools any size Moses basket, crib or cot, allowing parents to spend time with their deceased baby.

Specifications

- Cooling unit 27cm x 23cm x 13cm. Weight 3.8kg
- Does not contain refrigerant
- 115-240V, 50/60Hz, 200W, operating temperature range 8°C-13°C (48-55°F)
- Fuse rating is 4A/250V 4Amp 20 x 5mm Fuse 4A F4AL 250v Quick Blow
- UK/EU & AUZ models Class 1
- US/CSA model Class 2



Instruction Booklet



Not a medical device



parmed.com.au

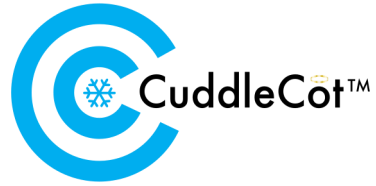

Warning

The appliance is not intended for use by children or persons with reduced physical, sensory or mental capabilities or lack of knowledge, unless they have been given supervision or instruction by a person responsible for their safety. Children should be supervised to ensure that they do not play with the appliance. The CuddleCot is for indoor use only, altitude up to 2000m, operating temp 5–25°C. Max relative humidity 80% at 23°C decreasing linearly to 50% at 25°C. Mains supply voltage fluctuations up to ±10% of the nominal voltage.

What's In the Box?

- CuddleCot™ cooling unit • Two soft cool pads; 1 standard for full term & 1 small pad for premature
- 3' / 90cm Hose
- Foil coated insulation
- Small bottle of biocide
- Drain Key
- Instruction manual

There is a short video to assist with set up on the dedicated CuddleCot page at parmed.com.au

Note

During storage purified water is left within the hose and cooling pad. The use of Flexmort's biocide neutralises bacteria and algae which could accumulate.

Using the CuddleCot system

1. To improve cooling efficiency, place the silver insulation under the cooling pad. Use double thickness and face the silver side upwards.
2. Place the cooling pad and insulation in the basket on top of the mattress (if present). Ensure the two hoses which lead from the pad are exposed and pushed through the basket. A thin sheet can be used to cover the cooling pad.
3. Remove the unit from the box, plug into the electrical socket.
4. Plug the cooling pad connectors into the end of the hose. Again there should be a "click".
5. Plug the hose containing the large plastic connector into the cooling unit. You should hear a "click".
6. Open the filler cap and place a couple of drops of biocide into the unit. Fill the cooling unit with purified water until the water level is near the top of the viewing window.
7. Switch on the cooling unit by pressing the on/off button. The cooling pad will start to fill and the water level will drop. Ensure there are no kinks in the hose or pad else fluid will not circulate. Continue to fill the unit with purified water until the tank remains over half full (the cooling pad will now be full of water). Always topped up during operation. An alarm will sound should the water level drop too low.
8. Select temperature display (°C or °F) by pressing the °C/°F button on the unit. The display will show the temperature of the water in the cooling unit. Set the required temperature to the lowest setting on the control unit (i.e. 8°C or 46°F). To do this, press and hold the down arrow key until

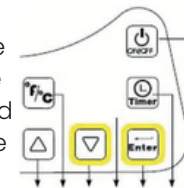
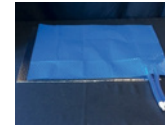

8 (or 46) is displayed, then press "Enter". The unit will begin to cool the cooling pad. When the pad starts to feel cool, place the baby on the pad. Within approximately 45 mins the display on the unit will reach between 8°C–13°C (48–55°F) depending on ambient conditions. These are normal operating temperatures and the cooling pad will feel cold.

9. Cover the baby with blankets as this will act as insulation. For longer term use (e.g. through the night), the baby can be fully covered with blankets (including the head).

10. Always ensure at least 15cm / 6" space remain around the unit during cooling.



N.B. only use purified water ie, distilled, de-ionised or sterilised

Troubleshooting

- The unit is beeping and a blue droplet appears on the display

The unit is low on water, see 7.

- The cooling pad is warm and not cooling 1. Ensure there are no kinks and the unit is set at 8°C/46°F. 2. There may be trapped air in the cooling pad. To remove, leave unit running and loosen the filler cap and roll the pad (like rolling a napkin) towards the hose inlet/outlet to remove the air.

SEE VIDEO AT WWW.FLEXMORT.COM/SERVICE

- The unit turns off after 30/60 minutes.

The system has a timer which may have been activated. To ensure the timer is off, press the Timer button until "0" is displayed. Continuous cooling is recommended.